

Personalization-Start

- ✦ Right-click on the **Desktop**.
- ✦ Select **Personalize** from the list.
- ✦ Click the **Start** link.
- ✦ The **Start** window will display.

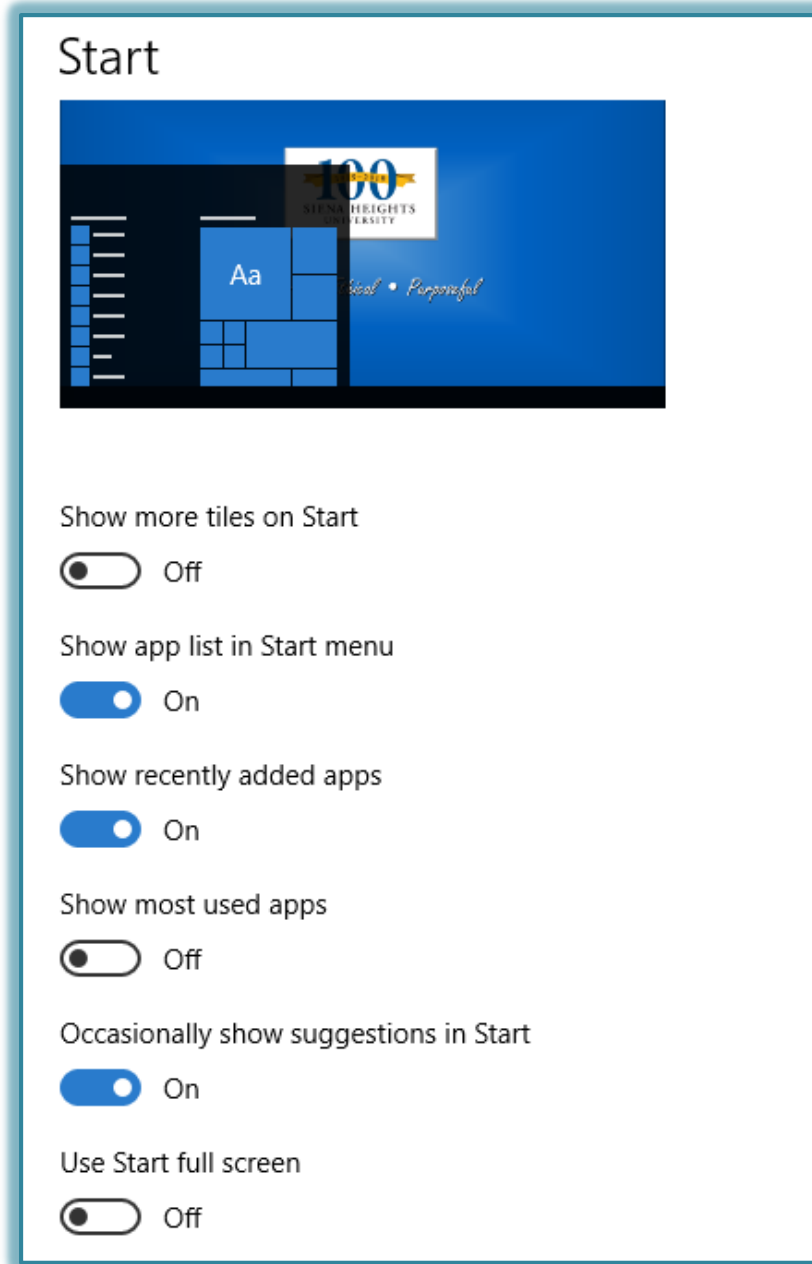

- ✦ Select either **On** or **Off** for any of the following options.
 - ✦ Show more tiles on Start
 - ✦ Show app list in Start Menu
 - ✦ Show recently added apps
 - ✦ Show most used apps
 - ✦ Occasionally show suggestions in Start
 - ✦ Use Start full screen

- ✦ Show recently opened items in Jump Lists on Start or the Taskbar
- ✦ Click the **Show which folders appear on Start** link to select from a list of folders, such as File Explorer, Settings, or Documents.