

Tab Settings

A tab is used to control the vertical spacing for certain items in the text. A Tab Stop is the location on a line of text where, when a Tab key is pressed, the insertion point is moved. When using a Tab, it isn't necessary to press the Spacebar. It also helps with the alignment of text when printing. Inserting spaces, when using proportional type, can sometimes print the text in a document with uneven margins. Using Tabs can help to prevent this from happening. Tab stops may be set using the ruler or the Tabs dialog box.

Tabs Dialog Box

- ✦ Click the **Home Tab**.
- ✦ In the **Paragraph Group**, click the **Paragraph Settings Dialog Box Launcher Button**.

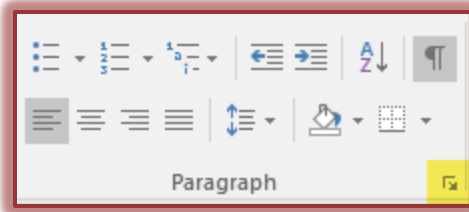

- ✦ The **Paragraph** dialog box will display.

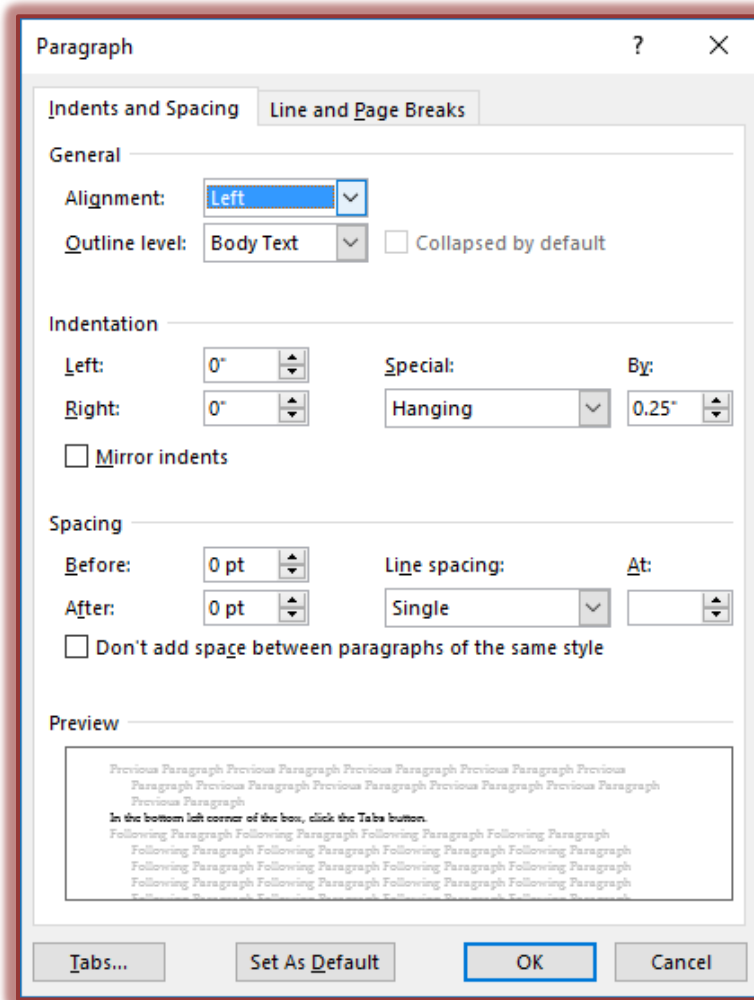

- ✦ In the bottom left corner of the box, click the **Tabs** button.
- ✦ The **Tabs** dialog box will display.

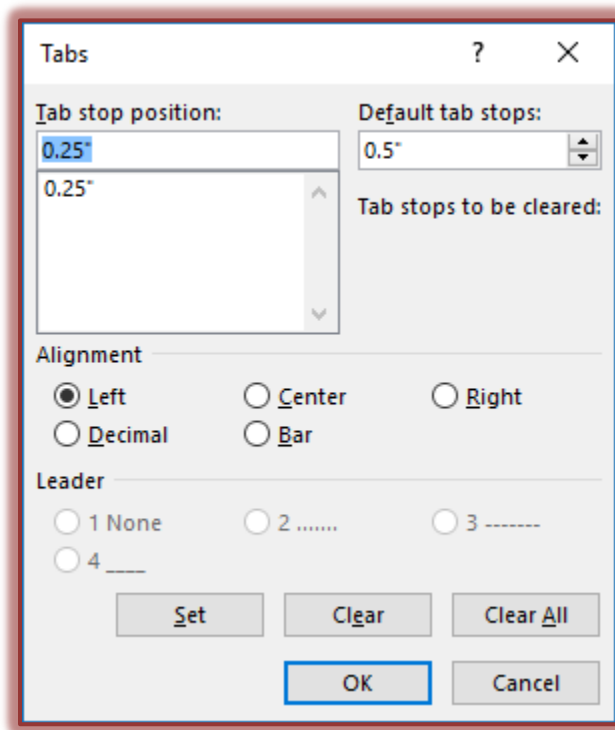

Tabs Dialog Box Options

Option	Description
Tab stop position	This option enables the user to enter individual measurement values, such as 1-inch.
Set	After a value has been entered, press Set to add the value to the list of tab settings.
Clear	If a tab stop needs to be cleared, select the value from the list and click the Clear button.
Clear All	To clear the entire tab list, click Clear All .
Default tab stops	To set the tabs every 0.5-inches in the document or for the selected text, click this option. Click the scrolling arrows to specify the default tab.
Alignment	
Left	This tab stop option left-aligns text at the tab stops. This is the default for all tab stops. Leaders cannot be set for this type of tab stop.
Center	Click the Center option button to center align the text at the tab stop. Leaders can be set for this type of tab stop.
Right	To right-align the text at the tab stop, click this option button. Leaders can be set for this type of tab stop.
Decimal	To align numbers at the decimal point, click this tab stop option button. This will align lists of numbers so the decimal points align with each other. Leaders can be set for this type of tab stop.

Option	Description
Bar	When this tab stop option button is clicked, a vertical bar will be inserted at the tab stop. Leaders cannot be set for this type of tab stop.
Leader	
A leader is a character that Word uses in a tab's blank area. It provides a path for the eye to follow across the page when a tab stop is applied to the text.	
1 - None	This option will remove leader characters. This is the default for all tab stops.
2 - Dot Leader (.)	To display a series of periods inside the tabs, select this option.
3 - Hyphen (- - - - -)	To display a series of hyphens inside the tabs, select this option.
4 - Underline (_ _ _ _)	Select this option to display a series of underlines inside the tabs.

Ruler Bar

The Ruler Bar (shown below) displays the Tab settings, indents, and margins. It can be used to change margins, tabs, and indents. Clicking with the left mouse button at the location on the Ruler Bar where the Tab is to be located sets tabs. The gray buttons on each end of the Ruler Bar are used to change margins and indents.





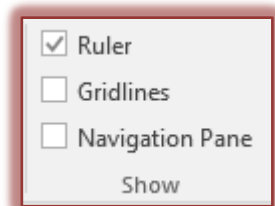



- ✦ If the Ruler Bar is not displayed:
 - ✦ Click the **View Tab**
 - ✦ In the **Show Group**, click the **Ruler** check box.
- ✦ To move the buttons, click and drag with the left mouse button.
- ✦ Changes to paragraphs can be made by clicking within the paragraph. It is not necessary to click at the beginning of the paragraph.
- ✦ To make changes to a portion of the text, select the text.
- ✦ The **Left Margin** can be changed by clicking and dragging the bottom **rectangle** shape on the left side of the **Ruler Bar**.
- ✦ The **Right Margin** can be changed by clicking and dragging the **triangle** shaped button on the right side of the **Ruler Bar**.
- ✦ A **Hanging Indent** can be set by clicking and dragging the **top triangle** shape on the left side of the **Ruler Bar**. A **Hanging Indent** is when the first line of text starts at the left margin and the rest of the lines are indented.
- ✦ A **First Line Indent** can be set by clicking and dragging the **bottom triangle** on the left side of the **Ruler Bar**.
- ✦ The table below describes each of the options in the Ruler Bar.



Button	Used to
Tab Type Buttons	These buttons are used to set different types of tabs on the Ruler Bar. This is a toggle button that changes to Left Tab (default), Center Tab, Right Tab, Decimal Tab, Bar Tab, First Line Indent, and Hanging Indent. Click the button to scroll through the different tab types.
Margin Buttons	Set the margins on the left and right side of the document. On the left side, the bottom rectangular box is used to set the left margin.
Indent Button	Set the indents for a paragraph. The bottom triangle sets the Hanging Indent (first line at left margin, rest of lines indented), and the top triangle shape sets the First Line Indent (first line indented, the rest of lines at left margin).

- ✦ The **Tab Stops** can be changed by clicking and dragging the **Tab Stops**. These are the black symbols on the **Ruler Bar**.
- ✦ To change the type of tab stop, click the **Tab Type Button**. This is a toggle button that scrolls through the different tab stops. Continue to click the button until you locate the desired type of **Tab Stop**.

Tab Stop Types

Tab Stop Type	Description
Left	 This button is used to left-align text at the tab stops. This is the default for all tab stops.
Center	 Click the Center option button to center align the text at the tab stop.
Right	 To right-align the text at the tab stop, click this option button.
Decimal	 To align numbers at the decimal point, click this option button. This will align lists of numbers so the decimal points align with each other.
Bar	 When this option button is clicked, a vertical bar will be inserted at the tab stop.
First Line Indent	 This tab stop is used to specify that the first line of the paragraph is indented. Click this option, and then click the upper half of the horizontal ruler where the first line of the paragraph is to begin.
Hanging Indent	 This button will set a Hanging Indent. A hanging indent is when the first line of the paragraph starts at the left margin and all the rest of the paragraph is indented. Click this button, and then click the lower half of the horizontal ruler where the second line and all subsequent lines of the paragraph will begin.